

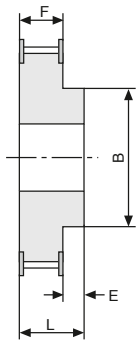

## PULLEY INFORMATION

### PULLEY TYPES



**Type 1F**

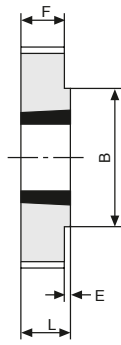

**Type 2**

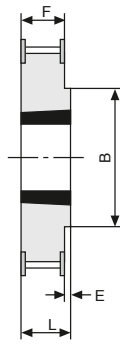

**Type 2F**

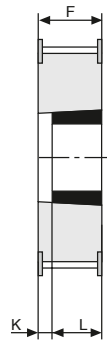

**Type 3F**

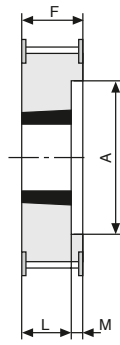

**Type 5F**

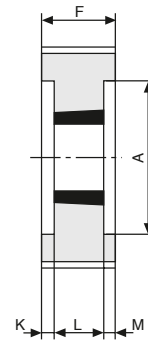

**Type 6**

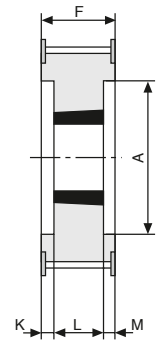

**Type 6F**

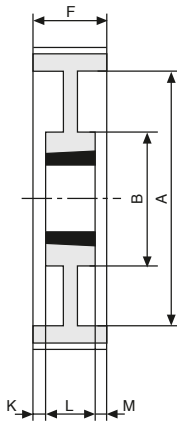

**Type 7**

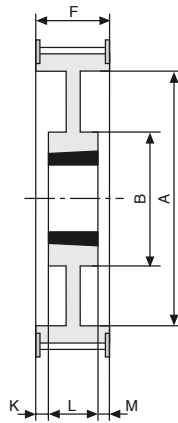

**Type 7F**

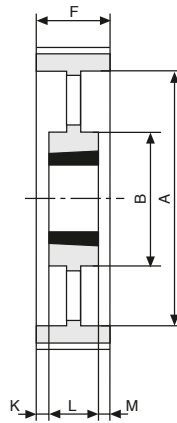

**Type 8**

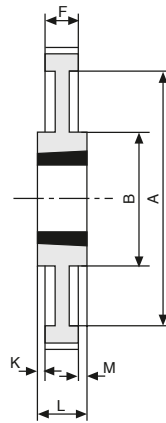

**Type 9**

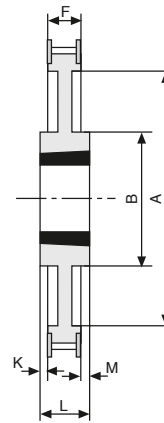

**Type 9F**

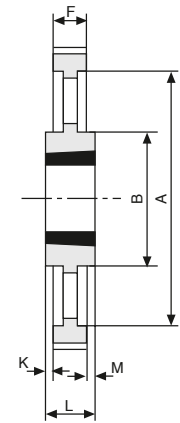

**Type 10**

# 38 SPROCKETS POLY CHAIN® GT™ 8MGT - 14MGT



## PULLEY INFORMATION

**Notes:** Pulleys of cast iron or steel material are supplied. Pulleys of either material provide required durability and service life. Gates reserves the right to supply pulleys of either material against orders for standard pulleys.  
**Specification:** cast iron 220 N/mm<sup>2</sup> / steel 220 M07.

## PULLEY SPECIFICATIONS

Pulley designation	No. of teeth	Pulley type	Bush No.	Max. bore		Pitch	Diameters		A	B	E	F	K	L	M	Weight	Moment of Inertia
				Metric	Inch		mm	Flange									
8M-22S-12	22	1F	PB	28*	1.1/8	56.02	54.42	60	-	43	10	20	-	30	-	0.43	1.68
8M-25S-12	25	2F	1108	28	1.1/8	63.66	62.06	70	-	49	2	20	-	22	-	0.25	1.26
8M-28S-12	28	2F	1108	28	1.1/8	71.30	69.70	75	-	56	2	20	-	22	-	0.37	2.35
8M-30S-12	30	2F	1210	32	1.1/4	76.39	74.79	82.5	-	60	5	20	-	25	-	0.41	2.99
8M-32S-12	32	2F	1610	42	1.5/8	81.49	79.89	87	-	66	5	20	-	25	-	0.37	3.07
8M-34S-12	34	2F	1610	42	1.5/8	86.58	84.98	91	-	69	5	20	-	25	-	0.45	4.21
8M-36S-12	36	2F	1610	42	1.5/8	91.67	90.07	97	-	76	5	20	-	25	-	0.59	6.19
8M-38S-12	38	2F	1610	42	1.5/8	96.77	95.17	102	-	78	5	20	-	25	-	0.70	8.19
8M-40S-12	40	2F	1610	42	1.5/8	101.86	100.26	106	-	85	5	20	-	25	-	0.82	10.63
8M-45S-12	45	2F	2012	50	2	114.59	112.99	120	-	92	12	20	-	32	-	1.10	18.05
8M-48S-12	48	2F	2012	50	2	112.23	120.63	128	-	103	12	20	-	32	-	1.42	26.51
8M-50S-12	50	2F	2012	50	2	127.32	125.72	135	-	104	12	20	-	32	-	1.60	32.42
8M-56S-12	56	2F	2012	50	2	142.60	141.00	150	-	104	12	20	-	32	-	2.10	53.37
8M-60S-12	60	2F	2012	50	2	152.79	151.19	158	-	111	12	20	-	32	-	2.40	70.03
8M-64S-12	64	2F	2012	50	2	162.97	161.37	168	-	111	12	20	-	32	-	2.70	89.64
8M-75S-12	75	2	2012	50	2	190.99	189.39	-	-	111	12	20	-	32	-	3.70	188.70
8M-80S-12	80	2	2012	50	2	203.72	202.12	-	-	111	12	20	-	32	-	4.40	228.26
8M-90S-12	90	2	2012	50	2	229.18	227.58	-	-	111	12	20	-	32	-	5.50	361.10
8M-22S-21	22	1F	PB	28*	1.1/8	56.02	54.42	60	-	43	12	30	-	42	-	0.56	2.19
8M-25S-21	25	3F	1108	28	1.1/8	63.66	62.06	70	-	-	-	30	8	22	-	0.36	1.82
8M-28S-21	28	3F	1210	32	1.1/4	71.30	69.70	75	-	-	-	30	5	25	-	0.41	2.60
8M-30S-21	30	3F	1210	32	1.1/4	76.39	74.79	82.5	-	-	-	30	5	25	-	0.56	4.08
8M-32S-21	32	3F	1610	42	1.5/8	81.49	79.89	87	-	-	-	30	5	25	-	0.52	4.31
8M-34S-21	34	3F	1610	42	1.5/8	86.58	84.98	91	-	-	-	30	5	25	-	0.61	5.72
8M-36S-21	36	3F	1610	42	1.5/8	91.67	90.07	97	-	-	-	30	5	25	-	0.70	7.13
8M-38S-21	38	3F	1610	42	1.5/8	96.77	95.17	102	-	-	-	30	5	25	-	0.92	10.72
8M-40S-21	40	3F	1610	42	1.5/8	101.86	100.26	106	-	-	-	30	5	25	-	1.06	13.75
8M-45S-21	45	2F	2012	50	2	114.59	112.99	120	-	92	2	30	-	32	-	1.30	21.33
8M-48S-21	48	2F	2012	50	2	122.23	120.63	128	-	103	2	30	-	32	-	1.60	29.88
8M-50S-21	50	2F	2012	50	2	127.32	125.72	135	-	104	2	30	-	32	-	1.83	37.08
8M-56S-21	56	2F	2012	50	2	142.60	141.00	150	-	111	2	30	-	32	-	2.40	61.00
8M-60S-21	60	2F	2517	60	2.1/2	152.79	151.19	158	-	124	15	30	-	45	-	3.20	93.37
8M-64S-21	64	2F	2517	60	2.1/2	162.97	161.37	168	-	124	15	30	-	45	-	3.80	126.15
8M-75S-21	75	2	2517	60	2.1/2	190.99	189.39	-	-	124	15	30	-	45	-	5.20	237.10
8M-80S-21	80	2	2517	60	2.1/2	203.72	202.12	-	-	124	15	30	-	45	-	6.00	311.41
8M-90S-21	90	9	2517	60	2.1/2	229.18	227.58	-	-	198	124	-	30	7.5	45	7.5	354.53
8M-112S-21	112	9	2517	60	2.1/2	285.21	283.61	-	-	253	124	-	30	7.5	45	7.5	752.44
8M-140S-21	140	10	3020	75	3	356.51	354.91	-	-	324	150	-	30	10.5	51	10.5	1429.86

\* Max. bore to be fitted with shallow keys.

PB = Plain Bored Bush.

For peripheral speeds greater than 40 m/sec consult Gates.

# 38 SPROCKETS POLY CHAIN® GT™ 8MGT - 14MGT



## PULLEY INFORMATION

**Notes:** Pulleys of cast iron or steel material are supplied. Pulleys of either material provide required durability and service life. Gates reserves the right to supply pulleys of either material against orders for standard pulleys.  
**Specification:** cast iron 220 N/mm<sup>2</sup> / steel 220 M07.

## PULLEY SPECIFICATIONS

Pulley designation	No. of teeth	Pulley type	Bush No.	Max. bore		Diameters mm		Flange	A	B	E	F	K	L	M	Weight kg	Moment of inertia 10 <sup>-4</sup> kgm <sup>2</sup>
				Metric	Inch	Pitch	Outside										
8M-25S-36	25	1F	PB	32	1 1/4	63.66	62.06	70	-	49	10	45	-	55	-	1.04	5.26
8M-28S-36	28	3F	1210	32	1 1/4	71.30	69.70	75	-	-	-	45	-	-	-	0.64	4.06
8M-30S-36	30	3F	1610	42	1 5/8	76.39	74.79	82.5	-	-	-	45	-	-	-	0.59	4.30
8M-32S-36	32	3F	1610	42	1 5/8	81.49	79.89	87	-	-	-	45	-	-	-	0.79	6.55
8M-34S-36	34	3F	1610	42	1 5/8	86.58	84.98	91	-	-	-	45	-	-	-	0.93	8.71
8M-36S-36	36	3F	1610	42	1 5/8	91.67	90.07	97	-	-	-	45	-	-	-	1.15	12.07
8M-38S-36	38	3F	1610	42	1 5/8	96.77	95.17	102	-	-	-	45	-	-	-	1.39	16.27
8M-40S-36	40	3F	2012	50	2	101.86	100.26	106	-	-	-	45	-	-	-	1.34	17.37
8M-45S-36	45	3F	2012	50	2	114.59	112.99	120	-	-	-	45	-	-	-	1.87	30.69
8M-48S-36	48	3F	2012	50	2	122.23	120.63	128	-	-	-	45	-	-	-	2.20	41.09
8M-50S-36	50	3F	2012	50	2	127.32	125.72	135	-	-	-	45	-	-	-	2.70	54.71
8M-56S-36	56	3F	2517	60	2 1/2	142.60	141.00	150	-	-	-	45	-	-	-	3.00	76.26
8M-60S-36	60	3F	2517	60	2 1/2	152.79	151.19	158	-	-	-	45	-	-	-	3.80	110.88
8M-64S-36	64	3F	2517	60	2 1/2	161.97	161.37	168	-	-	-	45	-	-	-	4.50	149.40
8M-75S-36	75	2	3020	75	3	190.99	189.39	-	-	150	6	45	-	51	-	6.20	282.70
8M-80S-36	80	2	3020	75	3	203.72	202.12	-	-	150	6	45	-	51	-	7.40	383.89
8M-90S-36	90	9	3020	75	3	229.18	227.58	-	197	150	-	45	3	51	3	7.20	472.71
8M-112S-36	112	9	3020	75	3	285.21	283.61	-	253	150	-	45	3	51	3	10.40	1057.50
8M-140S-36	140	10	3020	75	3	356.51	354.91	-	324	150	-	45	3	51	3	12.70	2017.70
8M-168S-36	168	10	3525	100	4	427.81	426.21	-	396	198	-	45	10	65	10	21.50	4918.70
8M-192S-36	192	10	3525	100	4	488.92	487.32	-	457	198	-	45	10	65	10	27.00	8067.69
8M-30S-62	30	1F	PB	42	1 5/8	76.39	74.79	82.5	-	63	12	72	-	84	-	2.40	17.50
8M-32S-62	32	1F	PB	50*	2	81.49	79.89	87	-	68	12	72	-	84	-	2.80	23.24
8M-34S-62	34	1F	PB	55*	2 1/4	86.58	84.98	91	-	69	12	72	-	84	-	3.00	28.11
8M-36S-62	36	1F	PB	60*	2 1/2	91.67	90.07	97	-	76	12	72	-	84	-	3.40	35.71
8M-38S-62	38	1F	PB	60	2 1/2	96.77	95.17	102	-	78	12	72	-	84	-	3.80	44.48
8M-40S-62	40	3F	2012	50	2	101.86	100.26	106	-	-	-	72	-	-	-	2.06	26.71
8M-45S-62	45	3F	2012	50	2	114.59	112.99	120	-	-	-	72	-	-	-	3.00	49.24
8M-48S-62	48	3F	2517	60	2 1/2	122.23	120.63	128	-	-	-	72	-	-	-	2.90	54.51
8M-50S-62	50	3F	2517	60	2 1/2	127.32	125.72	135	-	-	-	72	-	-	-	3.25	65.85
8M-56S-62	56	6F	2517	60	2 1/2	142.60	141.00	150	111	-	-	72	13.5	45	13.5	3.90	99.13
8M-60S-62	60	6F	2517	60	2 1/2	152.79	151.19	158	121	-	-	72	13.5	45	13.5	4.70	137.15
8M-64S-62	64	6F	2517	60	2 1/2	162.97	161.37	168	131	-	-	72	13.5	45	13.5	5.60	185.91
8M-75S-62	75	6	3020	75	3	190.99	189.39	-	159	-	-	72	10.5	51	10.5	7.50	341.87
8M-80S-62	80	6	3020	75	3	203.72	202.12	-	172	-	-	72	10.5	51	10.5	9.20	477.21
8M-90S-62	90	6	3020	75	3	229.18	227.58	-	197	-	-	72	10.5	51	10.5	7.70	505.54
8M-112S-62	112	7	3020	75	3	285.21	283.61	-	253	150	-	72	10.5	51	10.5	12.10	1230.34
8M-140S-62	140	7	3525	100	4	356.51	354.91	-	324	198	-	72	3.5	65	3.5	22.70	3606.44
8M-168S-62	168	8	3525	100	4	427.81	426.21	-	396	198	-	72	3.5	65	3.5	26.80	6131.21
8M-192S-62	192	8	3525	100	4	488.92	487.32	-	457	198	-	72	3.5	65	3.5	34.20	10219.08

\* Max. bore to be fitted with shallow keys. PB = Plain Bored Bush. For peripheral speeds greater than 40 m/sec consult Gates.

# 38 SPROCKETS POLY CHAIN® GT™ 8MGT - 14MGT



## PULLEY INFORMATION

**Notes:** Pulleys of cast iron or steel material are supplied. Pulleys of either material provide required durability and service life. Gates reserves the right to supply pulleys of either material against orders for standard pulleys.  
**Specification:** cast iron 220 N/mm<sup>2</sup> / steel 220 M07.

## PULLEY SPECIFICATIONS

Pulley designation	No. of teeth	Pulley type	Bush No.	Max. bore		Pitch		Diameters		A	B	E	F	K	L	M	Weight	
				Metric	Inch	mm	Flange	kg	kgm <sup>2</sup>									
14M-28S-20	28	3F	2012	50	2	124.78	121.98	128	-	-	-	-	33	-	-	-	1.66	32.30
14M-30S-20	30	3F	2012	50	2	133.69	130.89	138	-	-	-	-	33	-	-	-	2.20	49.15
14M-32S-20	32	3F	2012	50	2	142.60	139.80	154	-	-	-	-	33	-	-	-	3.20	81.33
14M-34S-20	34	2F	2517	60	2 1/2	151.52	148.72	160	-	-	-	-	33	-	-	-	3.00	86.09
14M-36S-20	36	2F	2517	60	2 1/2	160.43	157.63	168	-	-	-	-	33	-	-	-	3.60	115.82
14M-38S-20	38	2F	2517	60	2 1/2	169.34	166.54	183	-	-	-	-	33	-	-	-	4.00	143.38
14M-40S-20	40	2F	2517	60	2 1/2	178.25	175.45	188	-	-	-	-	33	-	-	-	4.70	186.66
14M-44S-20	44	2F	3020	75	3	196.08	193.28	211	-	-	-	-	33	-	-	-	5.60	269.13
14M-48S-20	48	2F	3020	75	3	213.90	211.11	226	-	-	-	-	33	-	-	-	6.80	388.90
14M-50S-20	50	2F	3020	75	3	222.82	220.02	240	-	-	-	-	33	-	-	-	7.70	477.87
14M-56S-20	56	9F	3020	75	3	249.55	246.76	256	207	144	-	-	33	9	51	9	7.70	599.39
14M-60S-20	60	9	3020	75	3	267.38	264.58	-	224	159	-	-	33	9	51	9	8.50	759.60
14M-64S-20	64	9	3020	75	3	285.21	282.41	-	242	159	-	-	33	9	51	9	10.20	1037.15
14M-72S-20	72	9	3020	75	3	320.86	318.06	-	278	159	-	-	33	9	51	9	11.50	1479.92
14M-80S-20	80	9	3020	75	3	356.51	353.71	-	314	159	-	-	33	9	51	9	13.50	2144.80
14M-90S-20	90	10	3020	75	3	401.07	398.27	-	360	159	-	-	33	9	51	9	14.20	2855.21
14M-112S-20	112	10	3020	75	3	499.11	496.31	-	456	159	-	-	33	9	51	9	18.10	5636.13
14M-140S-20	140	10	3020	75	3	623.89	621.09	-	581	159	-	-	33	9	51	9	22.90	11429.96
14M-28S-37	28	5F	2012	50	2	124.78	121.98	128	88	-	-	-	51	-	32	19	2.20	42.81
14M-30S-37	30	6F	2517	60	2 1/2	133.69	130.89	138	98	-	-	-	51	-	45	3	2.50	55.85
14M-32S-37	32	6F	2517	60	2 1/2	142.60	139.80	154	100	-	-	-	51	-	45	3	3.00	76.25
14M-34S-37	34	6F	2517	60	2 1/2	151.52	148.72	160	109	-	-	-	51	-	45	3	3.80	109.05
14M-36S-37	36	5F	2517	60	2 1/2	160.43	157.63	168	117	-	-	-	51	-	45	6	4.30	138.34
14M-38S-37	38	5F	2517	60	2 1/2	169.34	166.54	183	126	-	-	-	51	-	45	6	5.10	182.81
14M-40S-37	40	5F	2517	60	2 1/2	178.25	175.45	188	135	-	-	-	51	-	45	6	6.00	238.30
14M-44S-37	44	3F	3020	75	3	196.08	193.28	211	-	-	-	-	51	-	-	-	7.00	336.41
14M-48S-37	48	3F	3020	75	3	213.90	211.11	226	-	-	-	-	51	-	-	-	9.00	514.72
14M-50S-37	50	3F	3020	75	3	222.82	220.02	240	-	-	-	-	51	-	-	-	10.00	620.61
14M-56S-37	56	7F	3020	75	3	249.55	246.76	256	207	144	-	-	51	-	51	0	9.20	745.88
14M-60S-37	60	7	3020	75	3	267.38	264.58	-	224	159	-	-	51	-	51	0	10.20	911.52
14M-64S-37	64	7	3020	75	3	285.21	282.41	-	242	159	-	-	51	-	51	0	12.20	1240.51
14M-72S-37	72	7	3020	75	3	320.86	318.06	-	278	159	-	-	51	-	51	0	13.40	1724.43
14M-80S-37	80	7	3020	75	3	356.51	353.71	-	314	159	-	-	51	-	51	0	16.10	2557.88
14M-90S-37	90	8	3020	75	3	401.07	398.27	-	360	159	-	-	51	-	51	0	17.20	3458.43
14M-112S-37	112	8	3020	75	3	499.11	496.31	-	456	159	-	-	51	-	51	0	23.00	7161.94
14M-140S-37	140	10	3525	100	4	623.89	621.09	-	581	206	-	-	51	-	65	7	41.00	19948.49
14M-168S-37	168	10	3525	100	4	748.66	745.87	-	706	206	-	-	51	-	65	7	51.50	36081.66
14M-192S-37	192	10	4030	115	4 1/2	855.61	852.82	-	812	215	-	-	51	-	76	12.5	60.00	54905.14

\* Max. bore to be fitted with shallow keys.

PB = Plain Bored Bush.

For peripheral speeds greater than 40 m/sec consult Gates.

# 38 SPROCKETS POLY CHAIN® GT™ 8MGT - 14MGT



## PULLEY INFORMATION

**Notes:** Pulleys of cast iron or steel material are supplied. Pulleys of either material provide required durability and service life. Gates reserves the right to supply pulleys of either material against orders for standard pulleys.  
**Specification:** cast iron 220 N/mm<sup>2</sup> / steel 220 M07.

## PULLEY SPECIFICATIONS

Pulley designation	No. of teeth	Pulley type	Bush No.	Max. bore		Diameters mm		A	B	E	F	K	L	M	Weight kg	Moment of inertia 10 <sup>-4</sup> kgm <sup>2</sup>	
				Metric	Inch	Pitch	Outside										Flange
14M-34S-68	34	1F	PB	100	4	151.52	148.72	160	-	132	20	84	-	104	-	10.50	301.33
14M-36S-68	36	1F	PB	100	4 1/4	160.43	157.63	168	-	131	20	84	-	104	-	11.70	376.42
14M-38S-68	38	1F	PB	115*	4 1/2	169.34	166.54	183	-	141	20	84	-	104	-	13.40	481.46
14M-40S-68	40	1F	PB	125*	5	178.25	175.45	188	-	156	20	84	-	104	-	15.40	611.63
14M-44S-68	44	6F	3020	75	3	196.08	193.28	211	153	-	-	84	16.5	51	16.5	9.20	442.14
14M-48S-68	48	5F	3020	75	3	213.90	211.11	226	171	-	-	84	-	51	33	11.30	646.26
14M-50S-68	50	6F	3525	100	4	222.82	220.02	240	180	-	-	84	9.5	65	9.5	15.50	775.76
14M-56S-68	56	6F	3525	100	4	249.55	246.76	256	207	-	-	84	9.5	65	9.5	16.80	1307.78
14M-60S-68	60	6	3525	100	4	267.38	264.58	-	224	-	-	84	9.5	65	9.5	20.40	1823.05
14M-64S-68	64	6	3525	100	4	285.21	282.41	-	242	-	-	84	9.5	65	9.5	23.60	2399.67
14M-72S-68	72	7	3525	100	4	320.86	318.06	-	278	178	-	84	9.5	65	9.5	20.30	2612.89
14M-80S-68	80	7	3525	100	4	356.51	353.71	-	314	178	-	84	9.5	65	9.5	21.30	3384.02
14M-90S-68	90	8	3525	100	4	401.07	398.27	-	360	178	-	84	9.5	65	9.5	24.40	4966.46
14M-112S-68	112	8	3525	100	4	499.11	496.31	-	456	178	-	84	9.5	65	9.5	32.70	10182.40
14M-140S-68	140	8	3525	100	4	623.89	621.09	-	581	206	-	84	9.5	65	9.5	55.00	26760.16
14M-168S-68	168	8	3525	100	4	748.66	745.87	-	706	206	-	84	9.5	65	9.5	71.00	49743.65
14M-192S-68	192	8	4030	115	4 1/2	855.61	852.82	-	812	215	-	84	4	76	4	80.50	73664.39
14M-36S-90	36	1F	PB	110	4 1/4	160.43	157.63	168	-	131	30	106	-	136	-	14.50	466.50
14M-38S-90	38	1F	PB	115	4 1/2	169.34	166.50	183	-	141	30	106	-	136	-	17.50	627.29
14M-40S-90	40	1F	PB	125	5 1/2	178.25	175.45	188	-	156	30	106	-	136	-	19.10	758.59
14M-44S-90	44	1F	PB	140	6 1/2	196.08	193.28	211	-	169	30	106	-	136	-	23.90	1150.95
14M-48S-90	48	6F	3525	100	4	213.90	211.11	226	171	-	-	106	20	66	20	12.70	726.33
14M-50S-90	50	6F	3525	100	4	222.82	220.02	240	180	-	-	106	20	66	20	14.50	899.88
14M-56S-90	56	6F	3525	100	4	249.55	246.76	256	207	-	-	106	20	66	20	19.00	1479.04
14M-60S-90	60	6	3525	100	4	267.38	264.58	-	224	-	-	106	20	66	20	22.50	2010.71
14M-64S-90	64	6	3525	100	4	285.21	282.41	-	242	-	-	106	20	66	20	24.00	2433.77
14M-72S-90	72	7	3525	100	4	320.86	318.06	-	278	178	-	106	20	66	20	22.60	2908.37
14M-80S-90	80	7	4030	115	4 1/2	356.51	353.71	-	314	215	-	106	15	76	15	27.00	4289.60
14M-90S-90	90	7	4030	115	4 1/2	401.07	398.27	-	360	215	-	106	15	76	15	34.10	6856.54
14M-112S-90	112	8	4535	125	5	499.11	496.31	-	456	215	-	106	8	90	8	46.00	14323.87
14M-140S-90	140	8	4535	125	5	623.89	621.09	-	581	215	-	106	8	90	8	61.00	29679.45
14M-168S-90	168	8	5040	130*	5	748.66	745.87	-	706	267	-	106	2	102	2	90.00	63055.33
14M-192S-90	192	8	5040	130*	5	855.61	852.82	-	812	267	-	106	2	102	2	108.50	93796.27

\* Max. bore to be fitted with shallow keys. For peripheral speeds greater than 40 m/sec consult Gates.

PB = Plain Bored Bush.

# 38 SPROCKETS POLY CHAIN® GT™ 8MGT - 14MGT



## PULLEY INFORMATION

**Notes:** Pulleys of cast iron or steel material are supplied. Pulleys of either material provide required durability and service life. Gates reserves the right to supply pulleys of either material against orders for standard pulleys.  
**Specification:** cast iron 220 N/mm<sup>2</sup> / steel 220 M07.

## PULLEY SPECIFICATIONS

Pulley designation	No. of teeth	Pulley type	Bush No.	Max. bore		Diameters		A	B	E	F	K	L	M	Weight	Moment of inertia 10 <sup>-4</sup>	
				Metric	Inch	mm	Flange										
14M-38S-12S	38	1F	PB	115*	4 1/2	169.34	166.54	183	-	141	20	141	-	161	-	20.30	727.65
14M-40S-12S	40	1F	PB	125*	5	178.25	175.45	188	-	156	20	141	-	161	-	23.00	913.48
14M-44S-12S	44	1F	PB	140*	5 1/2	196.08	193.28	211	-	169	20	141	-	161	-	28.80	1384.10
14M-48S-12S	48	1F	PB	160*	6 1/4	213.90	211.11	226	-	185	20	141	-	161	-	34.60	1978.83
14M-50S-12S	50	6F	3525	100	4	222.82	220.02	240	180	-	-	141	38	65	38	16.80	1042.62
14M-56S-12S	56	6F	3525	100	4	249.55	246.76	256	207	-	-	141	38	65	38	21.60	1681.43
14M-60S-12S	60	6	4030	115	4 1/2	267.38	264.58	-	224	-	-	141	32.5	76	32.5	25.60	2287.85
14M-64S-12S	64	6	4030	115	4 1/2	285.21	282.41	-	242	-	-	141	32.5	76	32.5	29.70	3024.16
14M-72S-12S	72	7	4030	115	4 1/2	320.86	318.06	-	278	215	-	141	32.5	76	32.5	30.00	3860.66
14M-80S-12S	80	7	4030	115	4 1/2	356.51	353.71	-	314	215	-	141	32.5	76	32.5	33.40	5306.40
14M-90S-12S	90	7	4030	115	4 1/2	401.07	398.27	-	360	215	-	141	32.5	76	32.5	39.40	7947.12
14M-112S-12S	112	8	4535	125	5	499.11	496.31	-	456	215	-	141	26	89	26	56.00	17437.76
14M-140S-12S	140	8	4535	125	5	623.89	621.09	-	581	215	-	141	26	89	26	73.00	35518.03
14M-168S-12S	168	8	5040	125	5	748.66	745.87	-	706	267	-	141	19.5	102	19.5	101.00	70762.02
14M-192S-12S	192	8	5040	125	5	855.61	852.82	-	812	267	-	141	19.5	102	19.5	121.50	111182.90

### MINIMUM STOCK BORES FOR PLAIN BORED (PB) PULLEYS

Pulley	Minimum bore mm	Pulley	Minimum bore mm
8M-22S-12	12.00	14M-34S-68	40.00
8M-22S-21	12.00	14M-36S-68	40.00
8M-25S-36	16.00	14M-38S-68	40.00
8M-30S-62	20.00	14M-40S-68	40.00
8M-32S-62	20.00	14M-36S-90	50.00
8M-34S-62	20.00	14M-38S-90	50.00
8M-36S-62	20.00	14M-40S-90	50.00
8M-38S-62	20.00	14M-44S-90	50.00
		14M-38S-125	50.00
		14M-40S-125	50.00
		14M-44S-125	50.00
		14M-48S-125	50.00

\* Max. bore to be fitted with shallow keys.

PB = Plain Bored Bush.

For peripheral speeds greater than 40 m/sec consult Gates.